



Submittal For Single Wall Spiral Oval Ductwork

Project Name: _____

Hranec Sheet Metal Inc.
763 McClellandtown Road
Uniontown PA 15401

www.hranec.com
Fax: 724-437-2233
Ph.: 724-437-2211

HRANEC CORP.



SUBMITTAL **Single Wall Spiral Oval**

INDEX

PAGE 1	FABRCATION FORM
PAGE 2	SPECIAL NOTES
PAGE 3	PRESSURE CLASS / OVAL REINFORCEMENT CHART
PAGE 4	HRANEC OVAL SIZING CHART
PAGE 5	CONNECTIONS
PAGE 6	SPIRAL OVAL DUCTWORK
PAGE 7	ELBOWS
PAGE 8	REDUCERS
PAGE 9	OVAL OR ROUND END SADDLE TAP
PAGE 10	END CAPS
PAGE 11	OFFSETS
PAGE 12	RECTANGULAR END SADDLE TAPS
PAGE 13	TEE'S & CROSSES
PAGE 14	OVAL VOLUME DAMPERS

SPECIAL NOTES:

- **SUBMITAL** = INCLUDES ALL AVAILABLE MATERIALS, CONNECTIONS AND PRESSURE CLASSES REFFERANCE OUR FABRICATION FORM FOR PROJECT SPECIFIC DUCTWORK INFORMATION. LISTED AS PAGE 1
- **FABRICATION** = ALL DUCTWORK IS FABRICATED PER SMACNA STANDARDS AND / PROJECT SPECIFICATIONS
- **MATERIALS FOR PAINTING** = RECOMMENDED MATERIAL FOR PAINTED SPIRAL DUCT = PAINT GRIP, HOWEVER GALVANIZED G90 CAN EASILY BE PAINTED WITH EXTRA PREP WORK.
- **PREP BEFORE PAINTING** = WE RECOMMENDED WIPING DOWN MINIMAL EXCESS LUBRICANT TWICE BEFORE PAINTING WITH DRY RAGS. IN ADDITION, WIPE DOWN WITH NO RINSE PREPAINT CLEANER #13158 (SHERWIN WILLIAMS) BEFORE APPLYING TWO COATS METAL PRIMER.
- **PAINT AND PRIMER** = ALL PRIMER AND PAINT SHOULD BE LABELED TO ADHERE TO METAL PAINTING APPLICATIONS. FOLLOW PAINT MANUFACTURERS APPLICATION PROCEDURES, TEMERATURE, HUMIDITY, SURFACE PREP WORK, ETC.
- **CAUTION** = IF A STEEL CABLE HANGING SYSTEM IS USED TO SUSPEND DUCT WORK, DO NOT APPLY PAINT, LUBRICANTS, OR OTHER COATINGS TO THE HANGING SYSTEM. FOLLOW HANING SYSTEM MANUFACTURERS INSTRUCTIONS
- **TESTING** = OUR SPIRAL OVAL DUCTWORK HAS BEEN EXTENSIVELY AIR TESTED FOR LOW, MEDIUM, & HIGH PRESSURES.
- **SEAMS** = LONGITUDINAL SEAMS ARE ALL BUTTON LOCK AND SEALED ON FITTINGS.
- **GAUGES** = METAL GAUGES ARE PRESSURE CLASS DRIVEN FROM LATEST SMACNA STANDARDS
- **SEALANT** = PROPER SEALING OF ALL COMPONENTS ESSPECIALLY CONNECTIONS. IS REQUIRED TO AVOID DARK AIR STREAKS AFTER INSTALLATION.
- **MATERIAL** = GALVANIZED, PAINT GRIP, SS304, SS316, PVC 4X4, ALUMINUM
- **WATER PROOF** = SPIRAL SEAM DUCT WORK IS NOT CONSTRUCTED TO BE WATER PROOF



OVAL REINFORCEMENT CHART

Flat Oval Duct Reinforcement Schedule and Standard Gauges on Pipe and Fittings

Flat Oval Duct Gauge for (+) Pressure up to 10 in. wg

Major Dimension	Spiral Seam Gauge	Fitting Gauge
To 24	24 ga.	20 ga.
25-30	22 ga.	20 ga.
31-36	22 ga.	20 ga.
37-42	22 ga.	18 ga.
43-48	22 ga.	18 ga.
49-54	20 ga.	18 ga.
55-60	20 ga.	18 ga.
61-66	20 ga.	16 ga.
71 and up	18 ga.	16 ga.

*per SMACNA HVAC Duct Construction Standards Metal and Flexible - 3rd Edition 2005

*all duct will meet or exceed specified gauges for all flat oval duct construction

Flat Oval Reinforcement Schedule

Flat Span	None Required	16 ga.	18 ga.	20 ga.	22 ga.	24 ga.
8" under	22 ga.					C - 5 ft.
9"-10"	20 ga.					C - 4 ft.
11"-12"	18 ga.	Not Required		C - 8 ft.	D - 5 ft.	D - 5 ft.
13"-14"	18 ga.			D - 8 ft.	D - 4 ft.	D - 3 ft.
15"-16"	16 ga.	E - 10 ft.		E - 5 ft.	N/A	E - 3 ft.
17"-18"	16 ga.	F - 10 ft.		F - 5 ft.	N/A	E - 3 ft.
19"-20"		G - 10 ft.	G - 8 ft.	F - 4 ft.	F - 3 ft.	E - 2.5 ft.
21"-22"		H - 10 ft.	H - 8 ft.	G - 4 ft.	F - 3 ft.	F - 2.5 ft.
23"-24"		I - 10 ft.	I - 8 ft.	H - 4 ft.	G - 3 ft.	F - 2.5 ft.
25"-26"		J - 8 ft.	H - 5 ft.	H - 4 ft.	G - 3 ft.	F - 2.5 ft.
27"-28"		I - 6 ft.	I - 5 ft.	N/A	H - 3 ft.	G - 2.5 ft.
29"-30"		J - 6 ft.	I - 5 ft.	N/A	H - 3 ft.	H - 2.5 ft.
31"-36"		J - 5 ft.	I - 4 ft.	1 - 3 ft.	H - 2.5 ft.	H - 2 ft.
37"-42"		J - 5 ft.	J - 4 ft.	1 - 2.5 ft.	I - 2 ft.	N/A
43"-48"		J - 4 ft.	J - 3 ft.	N/A	I - 2 ft.	N/A
49"-50"		L - 4 ft.	K - 3 ft.	1 - 2 ft.	N/A	N/A

- ALL GAUGE AND SIZE PIPE WILL BE SPIRAL SEAM
- ALL FITTINGS TO HAVE BUTTON LOCK AND SEAL TRANSVERSE SEAM
- ALL FITTINGS TO HAVE TACK WELD AND SEAL LONGITUDINAL SEAM



HRANEC OVAL SIZING CHART

Ovaler
Oval Size & Gauge Chart

Minor Axis	6	8	10	12	14	16	18	20	22	24	
Major Axis											
18.7	17.5	16.3									24 gauge
21.8	20.7	19.5	18.3								
25.0	23.8	22.7	21.5	20.3							
28.1	27.0	25.8	24.7	23.5	22.3						
31.3	30.1	29.0	27.8	26.7	25.5	24.3					
34.5	33.3	32.1	31.0	29.8	28.7	27.5	26.3				
37.6	36.5	35.3	34.1	33.0	31.8	30.7	29.5	28.3			
40.8	39.6	38.5	37.3	36.1	35.0	33.8	32.7	31.5	30.3		
44.0	42.8	41.6	40.5	39.3	38.1	37.0	35.8	34.7	33.5	22 gauge	
47.1	46.0	44.8	43.6	42.5	41.3	40.1	39.0	37.8	36.7		
50.3	49.1	48.0	46.8	45.6	44.5	43.3	42.1	41.0	39.8		
53.5	52.3	51.1	50.0	48.8	47.6	46.5	45.3	44.1	43.0	20 gauge	
56.6	55.5	54.3	53.1	52.0	50.8	49.6	48.5	47.3	46.1		
59.8	58.6	57.5	56.3	55.1	54.0	52.8	51.6	50.5	49.3		
62.9	61.8	60.6	59.5	58.3	57.1	56.0	54.8	53.6	52.5	18 gauge	
66.1	64.9	63.8	62.6	61.5	60.3	59.1	58.0	56.8	55.6		
69.3	68.1	66.9	65.8	64.6	63.5	62.3	61.1	60.0	58.5		
72.4	71.3	70.1	68.9	67.8	66.6	65.5	64.3	63.1	62.0	18 gauge	
75.6	74.4	73.3	72.1	70.9	69.8	68.6	67.5	66.3	65.1		
78.8	77.6	76.4	75.3	74.1	72.9	71.8	70.6	69.5	68.3		
81.9	80.8	79.6	78.4	77.3	76.1	74.9	73.8	72.6	71.5		
85.2	84.2	82.8	81.6	80.4	79.3	78.1	76.9	75.8	74.6		
		86.2	85.1	83.9	82.4	81.3	80.1	78.9	77.8		
				87.1	85.9	84.8	83.3	82.1	80.9		
					89.1	88.0	86.8	85.0	84.5		
						91.1	90.0	88.8	87.7		
							93.1	92.0	90.9		
								95.2	94.0		
									97.2		

Fitting Gauges

Major	Gauge
UP to 36"	20
37" to 60"	18
61" and UP	16



CONNECTIONS AVAILABLE FOR OVAL DUCT AND FITTINGS

1. **SLIP FIT = RECOMMENDED INSTALLATION = COUPLING CONNECTIONS TO BE CAULKED AND SCREWED EVERY 10"**

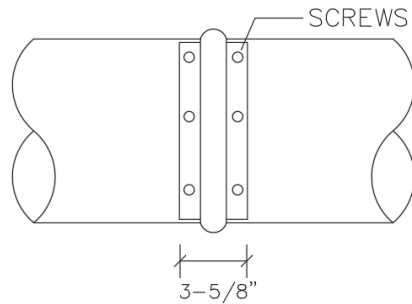

2. **SINGLE - WALL FLANGE = RECOMMENDED INSTALLATION = FLANGED CONNECTION TO BE GASKETED OR CAULKED AND SCREWED EVERY 10"**

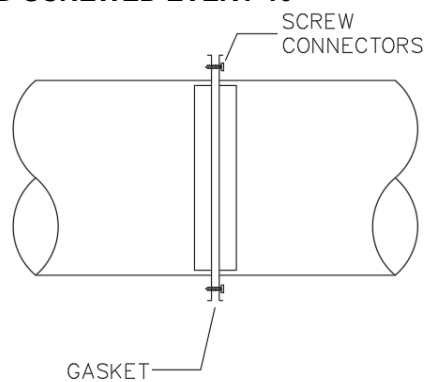

3. **ANGLE RING WITH OR WITHOUT BOLT HOLES= RECOMMENDED INSTALLATION= ANGLE RINGS WITHOUT BOLT HOLES TO HAVE FIELD FULLY WELDED CONNECTIONS WITH NO GASKET, ANGLE RINGS WITH BOLT HOLES TO BE GASKETED THEN NUT AND BOLTED USING THE BOLT HOLE PATTERN WITHOUT SKIPPING ANY HOLES. REFERENCE SMACNA FOR FULL INSTALLATION GUIDLINES**

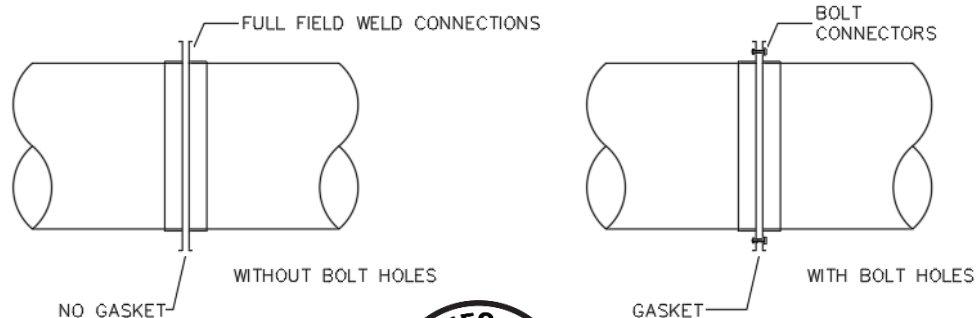

SPIRAL DUCT

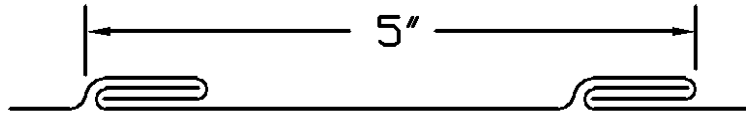

LATERAL SECTION OF 4-PLY PRESSURE PROOF SPIRAL SEAM

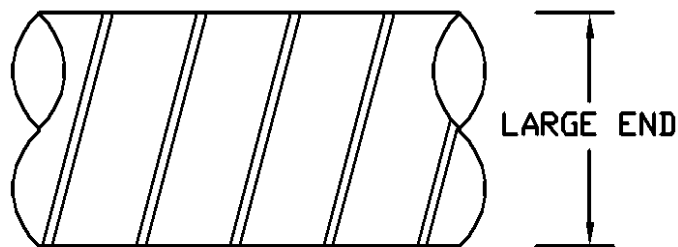

NOTES:

A. LENGTHS - 6" THROUGH 120"

B. REFFERANCE SIZE CHART ON PAGE 4 FOR OVAL DUCT SIZING



ELBOW

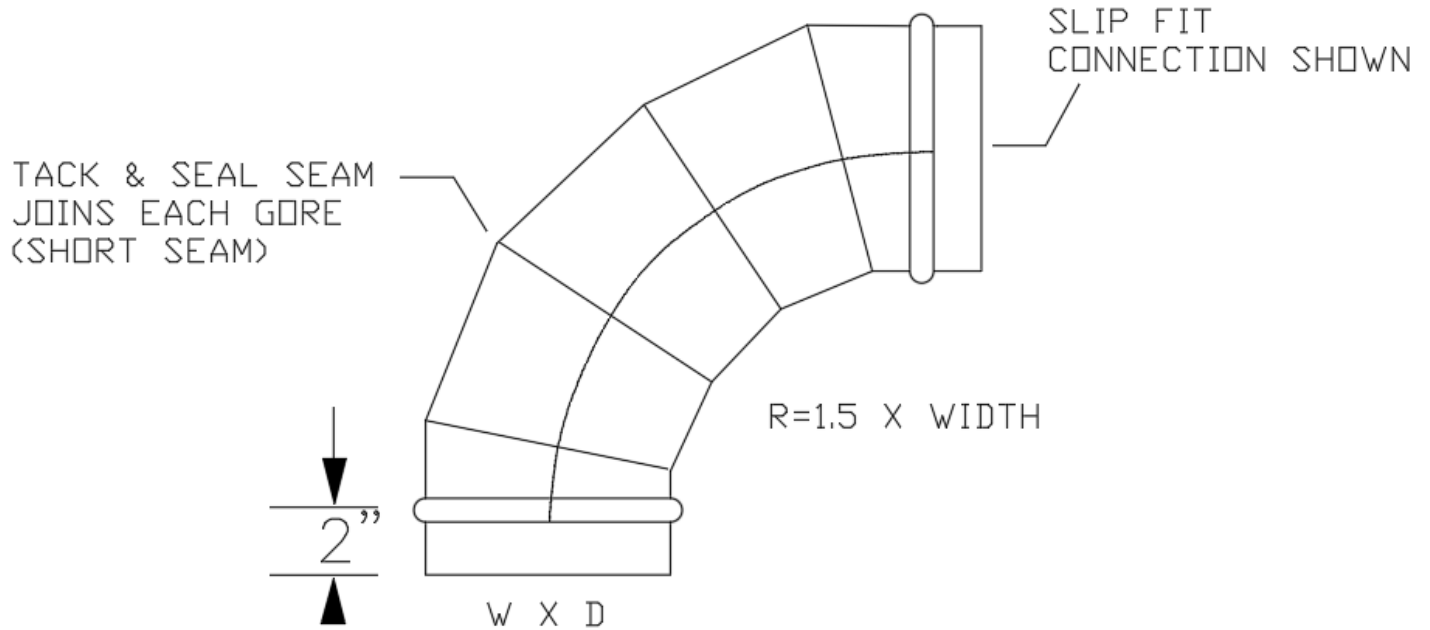

- **AVAILABLE IN 5° THROUGH 120°**
- **SHORT RADIUS ELBOWS ARE CONSIDERED 1 X WIDTH AND IS CENTERLINE**
- **OTHER RADIUS ELBOWS ARE AVAILABLE**



REDUCERS

CONCENTRIC REDUCER

$$X = \frac{D_1 - D_2}{2} \times 3$$

4" Minimum

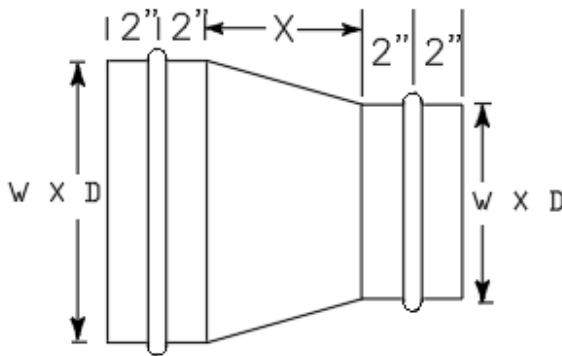

ECCENTRIC REDUCER

$$X = \frac{D_1 - D_2}{2} \times 3$$

4" Minimum

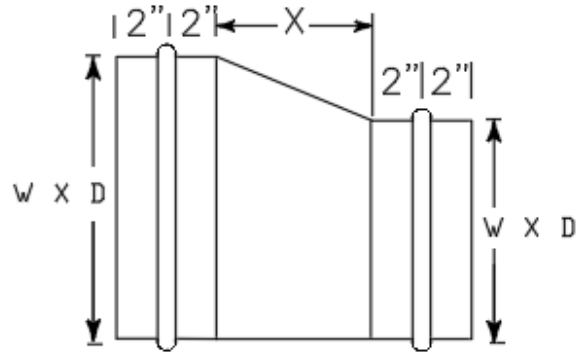

OFFSETTING REDUCER

$$X = 0 \times 3$$

4" Minimum

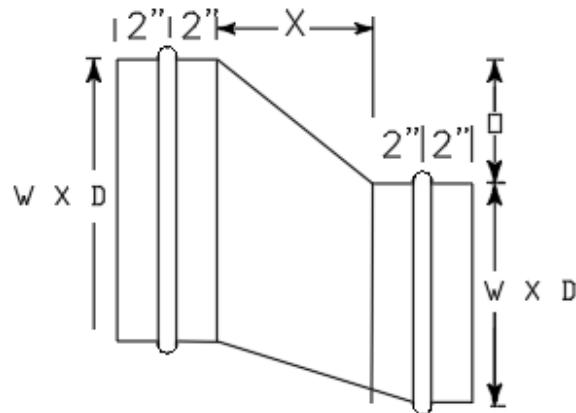

- **REDUCERS CAN TRANSITION TO ROUND SIZES**



OVAL OR ROUND END SADDLE TAPS

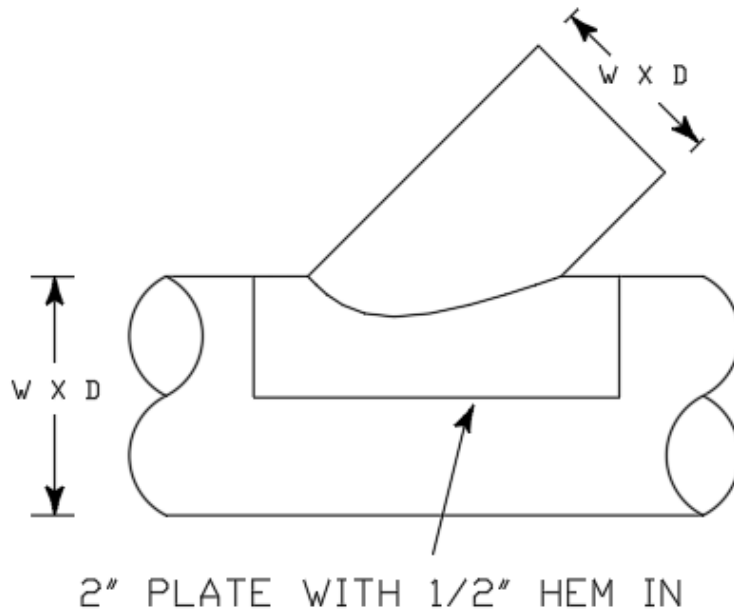

- **STANDARD 45 DEGREE&90 DEGREE ANGLES. ALTERNATE ANGLES AVAILABLE.**
- **90 DEGREE CONICAL AVAILABLE.**
- **HIGH EFFICIENCY SHOE STYLE AVAILABLE**
- **SADDLE TAPS CAN ALSO TRANSITION TO ROUND DUCT**

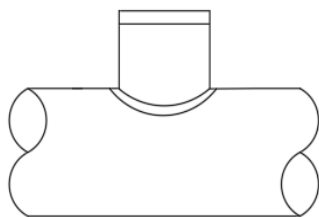

90 DEGREE SADDLE

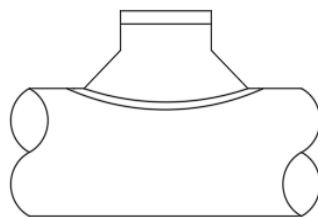

CONICAL SADDLE

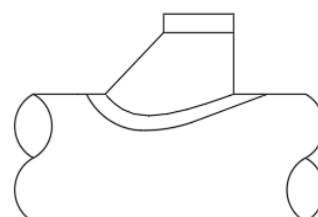

SHOE STYLE SADDLE



END CAPS

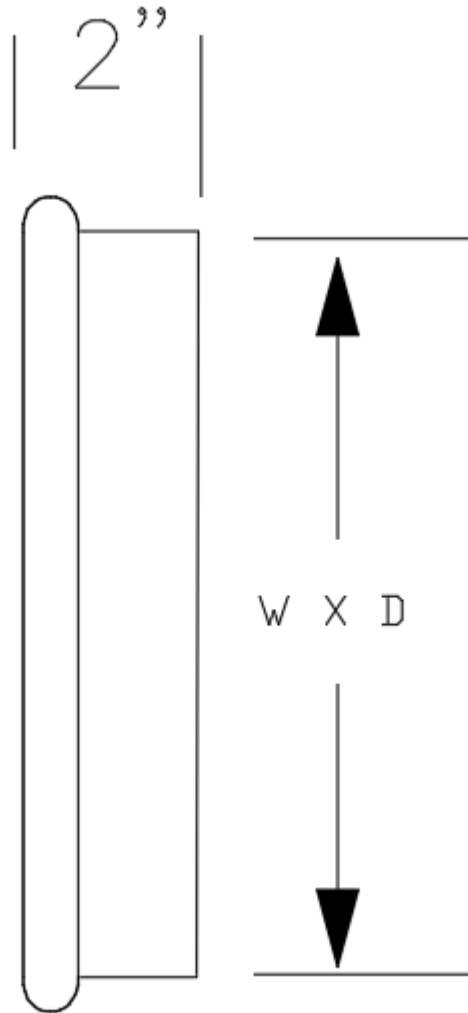

OFFSETS

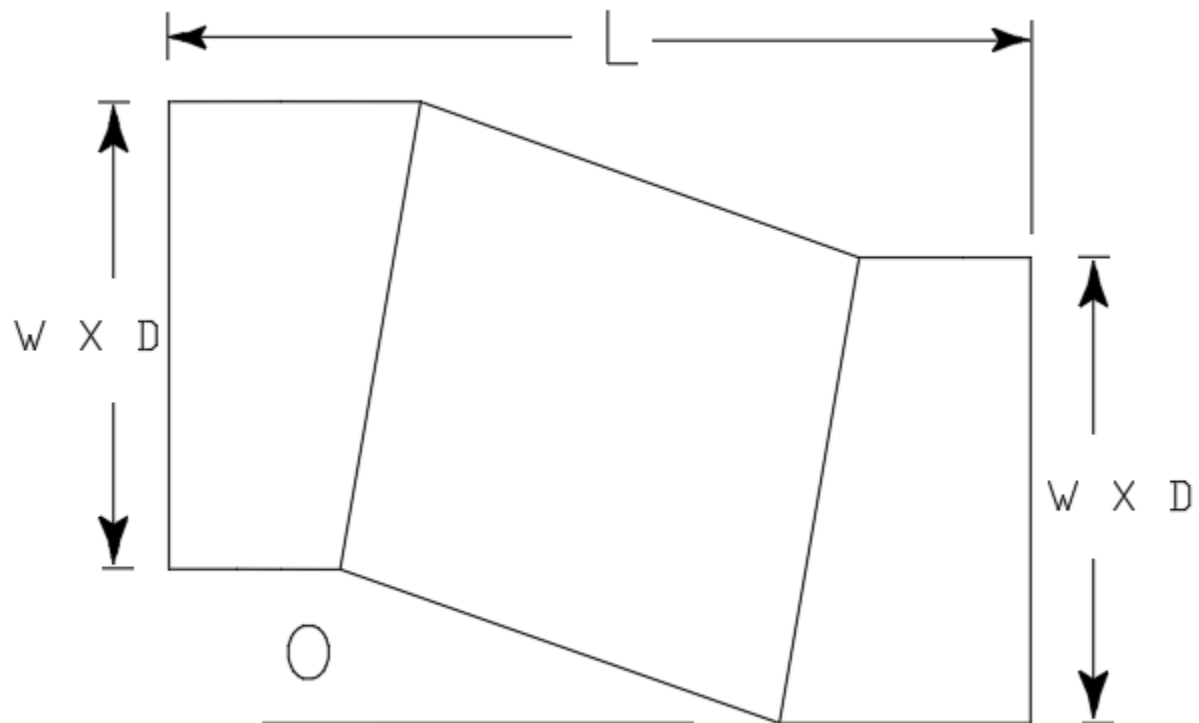

- **LENGTH TWO OR THREE TIMES THE OFFSET**



RECTANGULAR END SADDLE TAPS

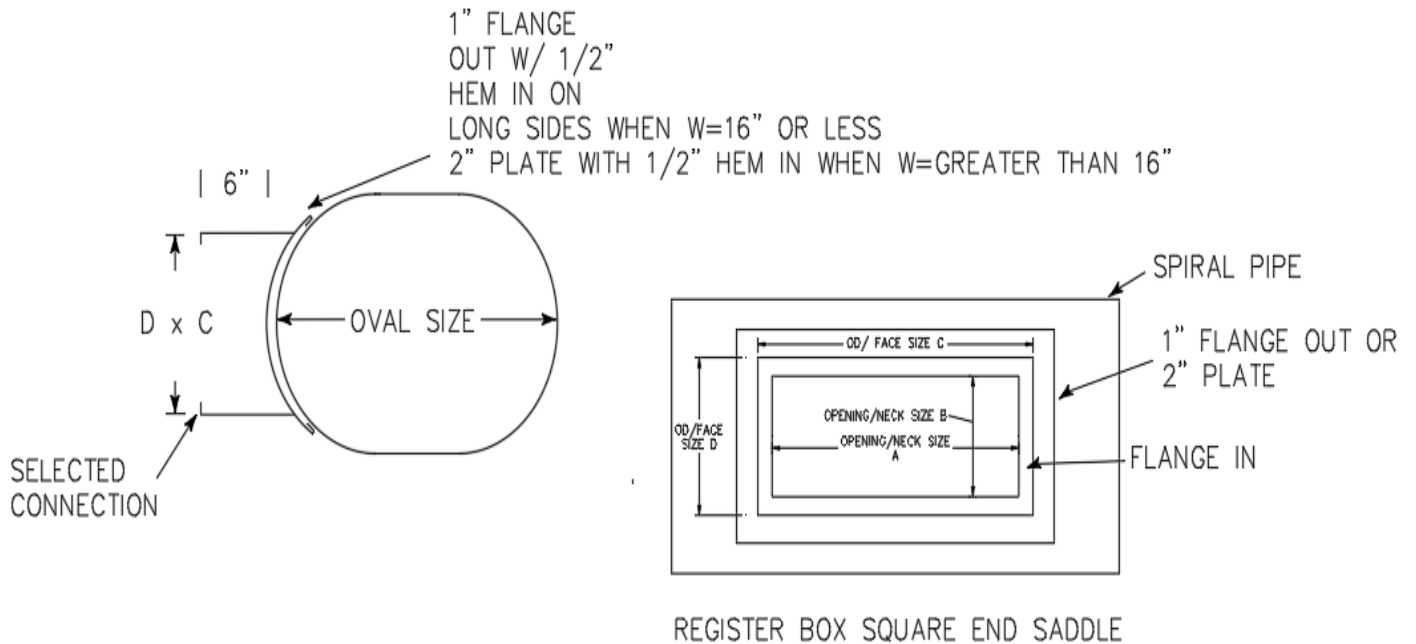

- **SPOT WELDED SEAMS USED ON BOXES**
- **STANDARD RECTANGULAR CONNECTION IS FLANGE IN**
- **ALTERNATE CONNECTIONS AVAILABLE: SLIP AND DRIVE, TDC, OR PREMANUFACTURED FLANGE FOR RECTANGULAR END**



TEES AND CROSSES

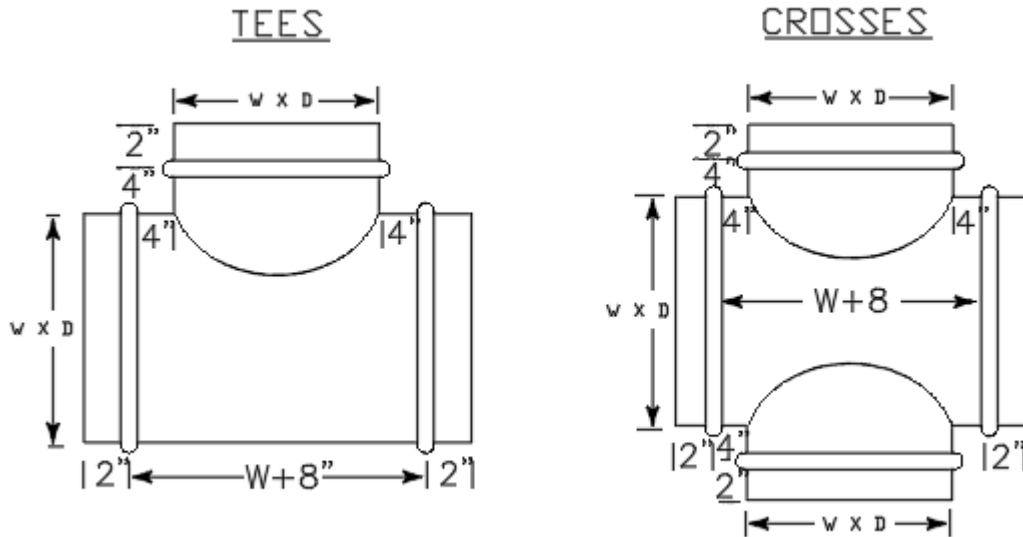

- **SEALED, TACK WELDED SEAMS, STITCH WELDED LONGITUDINAL SEAMS**
- **CONICAL, SHOE STYLE, 45 DEGREE LATERAL TEES AND CROSSES AVAILABLE**
- **REDUCING TEES AND LATERALS ALSO AVAILABLE**
- **TEE AND CROSSES CAN ALSO TRANSITION TO ROUND DUCT**



ROUND DAMPERS

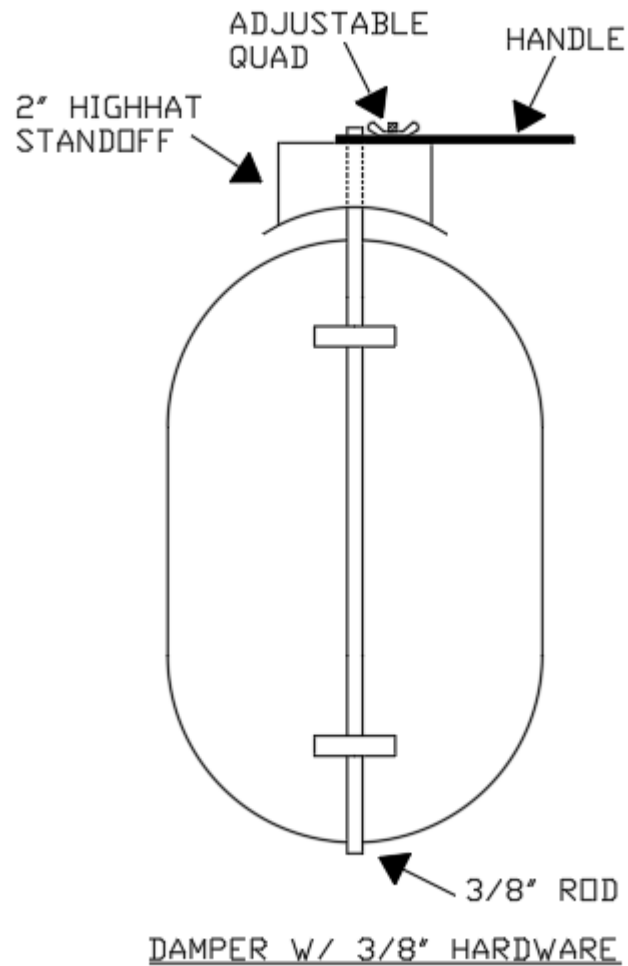

- **DAMPER AVAILABLE IN SLEEVES, LOOSE, OR INSTALLED IN SPIRAL PIPE AND FITTINGS**

