



Submittal For Single Wall PVC Coated Galvanized Spiral With Non-Gasketed Fittings

Hranec Sheet Metal Inc.
763 McClellandtown Road
Uniontown PA 15401

www.hranec.com
Fax: 724-437-2233
Ph.: 724-437-2211

HRANEC CORP.



SUBMITTAL
Single Wall Spiral

INDEX

| | |
|---------|------------------------------|
| PAGE 1 | FABRCATION FORM |
| PAGE 2 | SPECIAL NOTES |
| PAGE 3 | MAERIAL AND PRESSURE CLASSES |
| PAGE 4 | CONNECTIONS |
| PAGE 5 | SPIRAL DUCTWORK |
| PAGE 6 | GORE-LOCK ELBOWS |
| PAGE 7 | REDUCERS |
| PAGE 8 | ROUND END SADDLE TAP |
| PAGE 9 | END CAPS |
| PAGE 10 | OFFSETS |
| PAGE 11 | RECTANGULAR END SADDLE TAPS |
| PAGE 12 | ROUND TAPS OFF FLAT SURFACES |
| PAGE 13 | TEE'S & CROSSES |
| PAGE 14 | ROUND DAMPERS |

SPECIAL NOTES:

- **SUBMITTAL** = INCLUDES ALL AVAILABLE CONNECTIONS AND PRESSURE CLASSES REFERENCE OUR FABRICATION FORM FOR PROJECT SPECIFIC DUCTWORK INFORMATION. LISTED AS PAGE 1
- **FABRICATION** = ALL DUCTWORK IS FABRICATED PER SMACNA STANDARDS AND / PROJECT SPECIFICATIONS
- **CAUTION** = IF A STEEL CABLE HANGING SYSTEM IS USED TO SUSPEND DUCT WORK, DO NOT APPLY PAINT, LUBRICANTS, OR OTHER COATINGS TO THE HANGING SYSTEM. FOLLOW HANING SYSTEM MANUFACTURERS INSTRUCTIONS
- **TESTING** = OUR SPIRAL DUCTWORK HAS BEEN EXTENSIVELY AIR TESTED FOR LOW, MEDIUM, & HIGH PRESSURES.
- **SEAMS** = LONGITUDINAL SEAMS ARE ALL BUTTON LOCK ON FITTINGS.
- **GAUGES** = METAL GAUGES ARE PRESSURE CLASS DRIVEN FROM LATEST SMACNA STANDARDS
- **SEALANT** = PROPER SEALING OF ALL COMPONENTS ESSPECIALLY CONNECTIONS. IS REQUIRED TO AVOID DARK AIR STREAKS AFTER INSTALLATION.
- **MATERIAL** = PVC COATED GLAVANIZED G90, SEE MATERIAL AND PRESSURE CLASS SHEET FOR MORE INFOMATION
- **WATER PROOF** = SPIRAL SEAM DUCT WORK IS NOT CONSTRUCTED TO BE WATER PROOF



MATERIAL AND PRESSURE CLASSES

PVC COATED MATERIAL IS GALVANIZED G90 STEEL WITH A 4X4 MIL PVC COATING

- **POLYVINYL COATING IS .15-.25 BASE PRIMER BONDED TO BOTH SIDES AND 3.5-4.5 MILS PLASTISOL (POLYVINYL) HEAT FUSED TO BOTH SIDES**

POSITIVE PRESSURE

HRANEC PVC COATED GALVANIZED

2005 SMACNA +10WG -6WG

| Diameter | Fittings | Spiral |
|-----------------|-----------------|---------------|
| 3-9 | 28 | 28 |
| 9-14 | 28 | 28 |
| 15-18 | 26 | 26 |
| 19-24 | 24 | 26 |
| 25-42 | 22 | 24 |
| 43-60 | 20 | 22 |
| 61-66 | 18 | 22 |
| 67-96 | 18 | 20 |

HRANEC PIPE

| Size | Gauge |
|-------------|--------------|
| 4"-18" | 26 |
| 20-28 | 24 |
| 30-38 | 22 |
| 40-48 | 20 |
| 50-58 | 18 |
| 60-70 | 16 |

HRANEC FITTINGS

| Size | Gauge |
|-------------|--------------|
| 5"-20" | 24 |
| 22-36 | 22 |
| 38-50 | 20 |
| 52-60 | 18 |
| 62-70 | 16 |

- **ALL GAUGE AND DIAMETER PIPE WILL BE SPIRAL SEAM**
- **ALL FITTINGS 24 GAUGE TO 20 GAUGE TO HAVE GORELOCK TRANSVERSE SEAM**
- **ALL FITTINGS 24 GAUGE TO 20 GAUGE TO HAVE BUTTON LOCKED LONGITUDINAL SEAM**
- **ALL STEEL FITTINGS 18 GAUGE TO 16 GAUGE TO HAVE TACK WELDED AND SEALED TRANSVERSE SEAM**
- **ALL STEEL FITTINGS 18 GAUGE TO 16 GAUGE TO HAVE TACK WELDED AND SEALED LONGITUDINAL SEAM**



CONNECTIONS AVAILABLE FOR ROUND DUCT AND FITTINGS

1. **SLIP FIT = RECOMMENDED INSTALLATION = COUPLING CONNECTIONS TO BE CAULKED AND SCREWED EVERY 10" AROUND THE DIAMETER**

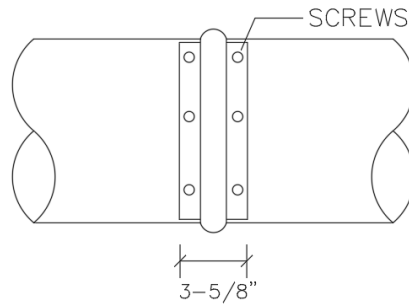

2. **SINGLE - WALL FLANGE = RECOMMENDED INSTALLATION = FLANGED CONNECTION TO BE GASKETED OR CAULKED AND SCREWED EVERY 10" AROUND THE DIAMETER**

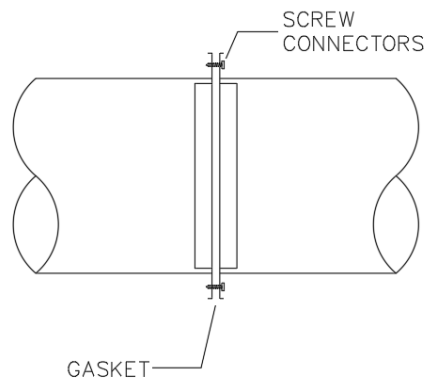

3. **ANGLE RING WITH OR WITHOUT BOLT HOLES= RECOMMENDED INSTALLATION= ANGLE RINGS WITHOUT BOLT HOLES TO HAVE FIELD FULLY WELDED CONNECTIONS WITH NO GASKET, ANGLE RINGS WITH BOLT HOLES TO BE GASKETED THEN NUT AND BOLTED USING THE BOLT HOLE PATTERN WITHOUT SKIPPING ANY HOLES. REFERENCE SMACNA FOR FULL INSTALLATION GUIDLINES**

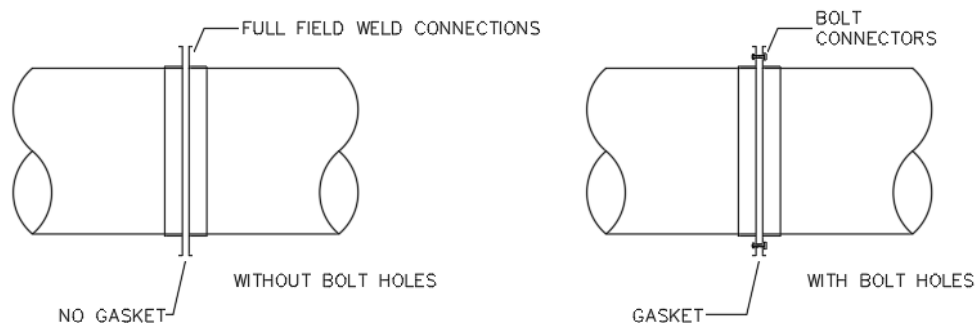

SPIRAL DUCT

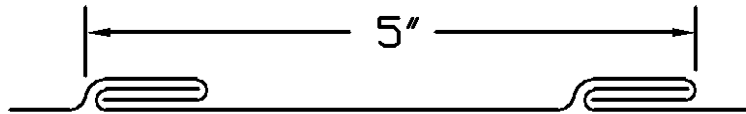

LATERAL SECTION OF 4-PLY PRESSURE PROOF
SPIRAL SEAM

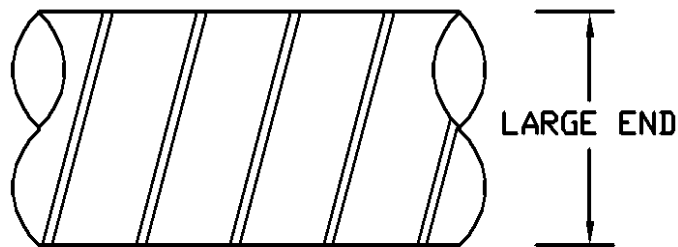

NOTES:

- A. AVAILABLE IN EVEN SIZES 4"Ø THROUGH 70" Ø
- B. AVAILABLE IN ODD SIZES 5"Ø, 7", & 9"Ø
- C. LENGTHS - 6" THROUGH 240" (STANDARD 120")



GORE-LOCK ELBOW

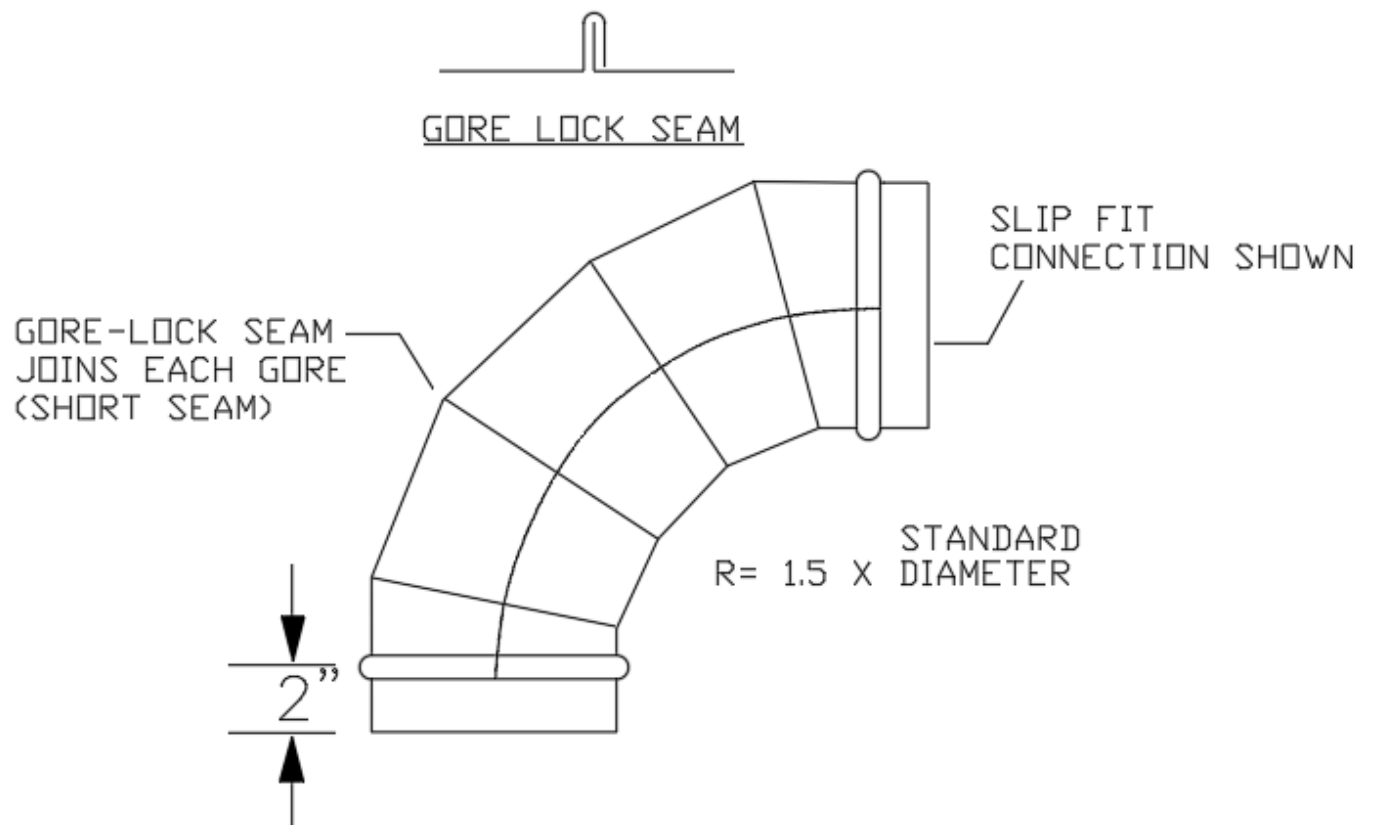

- AVAILABLE IN 5° THROUGH 120°
- SHORT RADIUS ELBOWS ARE CONSIDERED 1 X DIAMETER AND IS CENTERLINE
- OTHER RADIUS ELBOWS ARE AVAILABLE



REDUCERS

CONCENTRIC REDUCER

$$X = \frac{D_1 - D_2}{2} \times 3$$

4" Minimum

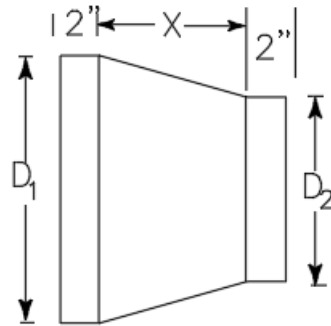

ECCENTRIC REDUCER

$$X = \frac{D_1 - D_2}{2} \times 3$$

4" Minimum

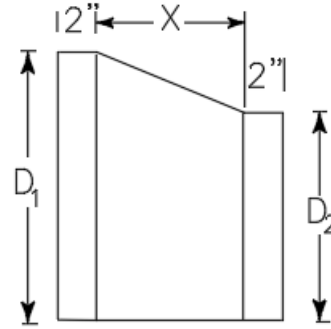

OFFSETTING REDUCER

$$X = O \times 3$$

4" Minimum

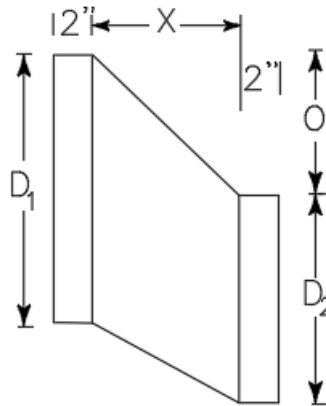

ROUND END SADDLE TAPS

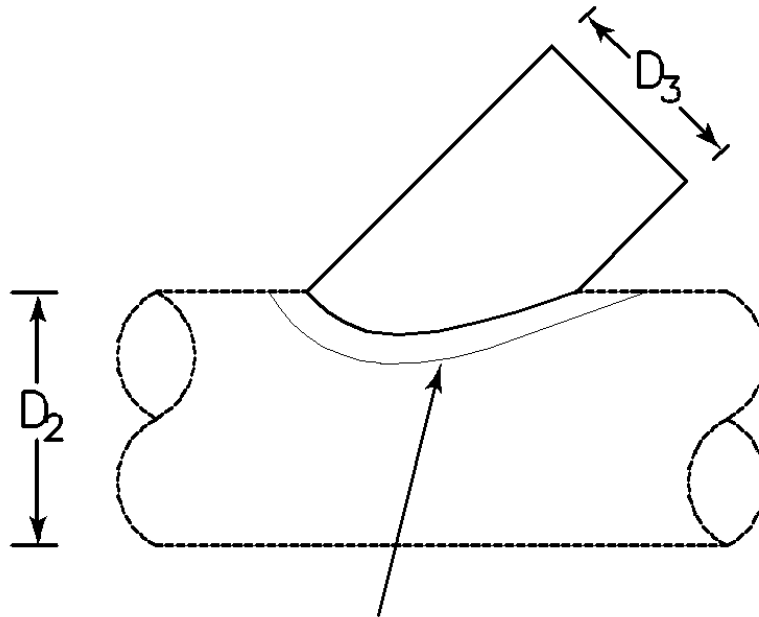

4"-16"= 1/2" FLANGE OUT
 18" AND ABOVE= 2" PLATE WITH 1/2" HEM IN

- STANDARD 45 DEGREE&90 DEGREE ANGLES. ALTERNATE ANGLES AVAILABLE.
- 90 DEGREE CONICAL AVAILABLE.
- HIGH EFFICIENCY SHOE STYLE AVAILABLE

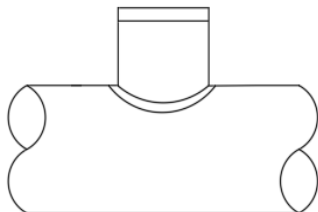

90 DEGREE SADDLE

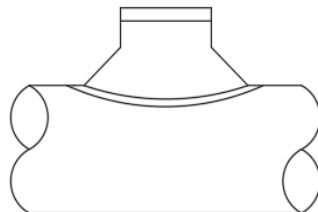

CONICAL SADDLE

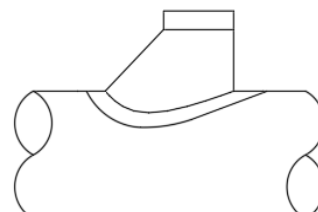

SHOE STYLE SADDLE



END CAPS

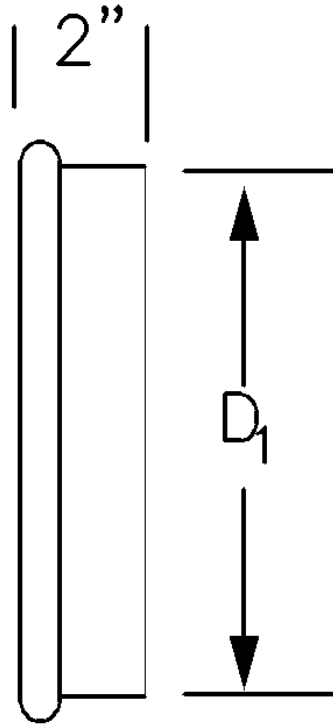

OFFSETS

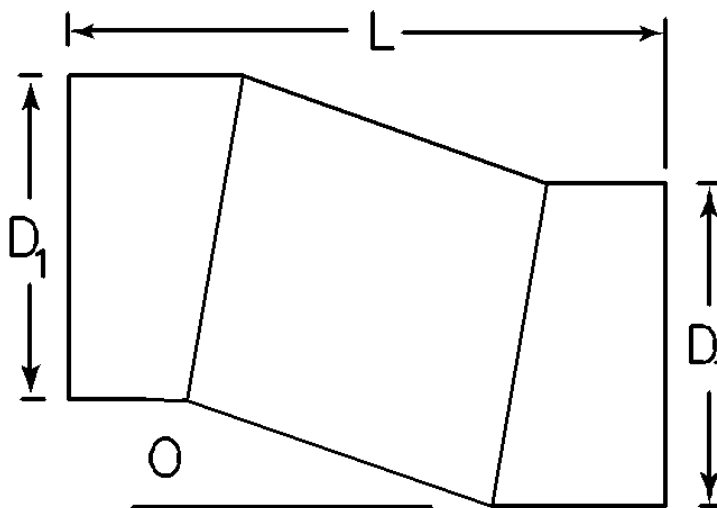

- LENGTH TWO OR THREE TIMES THE OFFSET



RECTANGULAR END SADDLE TAPS

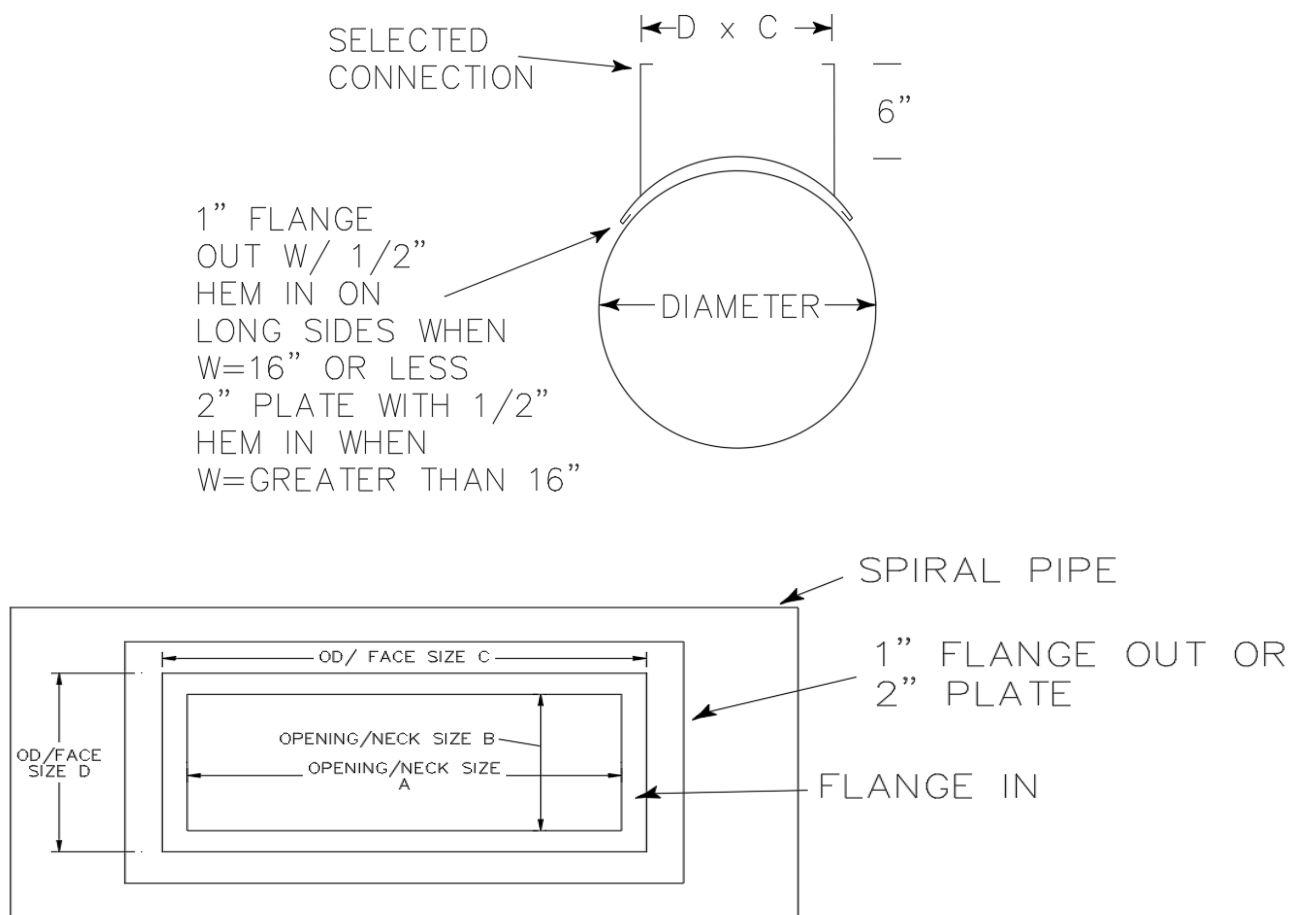

REGISTER BOX SQUARE END SADDLE

- **SPOT WELDED SEAMS USED ON BOXES**
- **STANDARD RECTANGULAR CONNECTION IS FLANGE IN**
- **ALTERNATE CONNECTIONS AVAILABLE: SLIP AND DRIVE, TDC, OR PREMANUFACTURED FLANGE FOR RECTANGULAR END**



ROUND TAPS OFF FLAT SURFACES

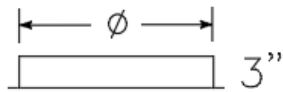

STRAIGHT STICK-ON

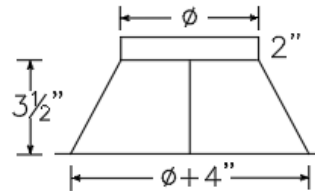

CONICAL STICK-ON

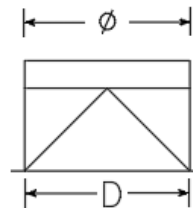
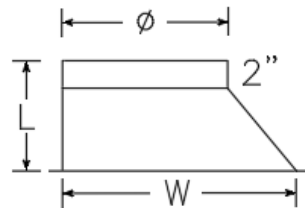

HIGH EFFICIENCY SIDE TAKE OFF

- **ALL TAPS HAVE 3/4" FLANGE OUT WITH 1/8" THICK GASKET.**
- **45 DEGREE LATERAL TAPS AVAILABLE**
- **INSTALLED DAMPERS AVAILABLE (SEE DAMPER SHEET FOR DETAILS)**



TEES AND CROSSES

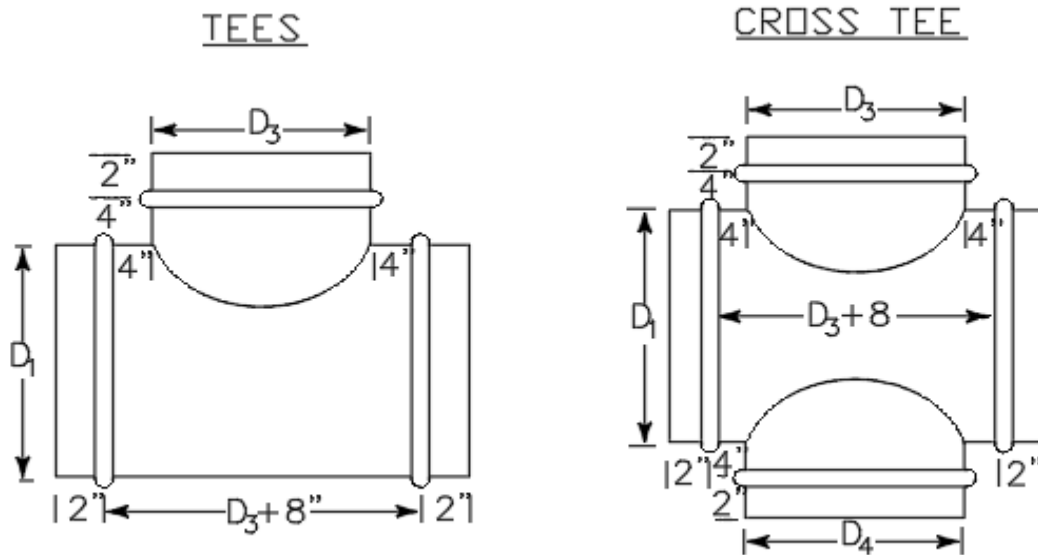

- **SEALED, TACK WELDED SEAMS, STITCH WELDED LONGITUDINAL SEAMS**
- **CONICAL, SHOE STYLE, 45 DEGREE LATERAL TEES AND CROSSES AVAILABLE**
- **REDUCING TEES AND LATERALS ALSO AVAILABLE**



ROUND DAMPERS

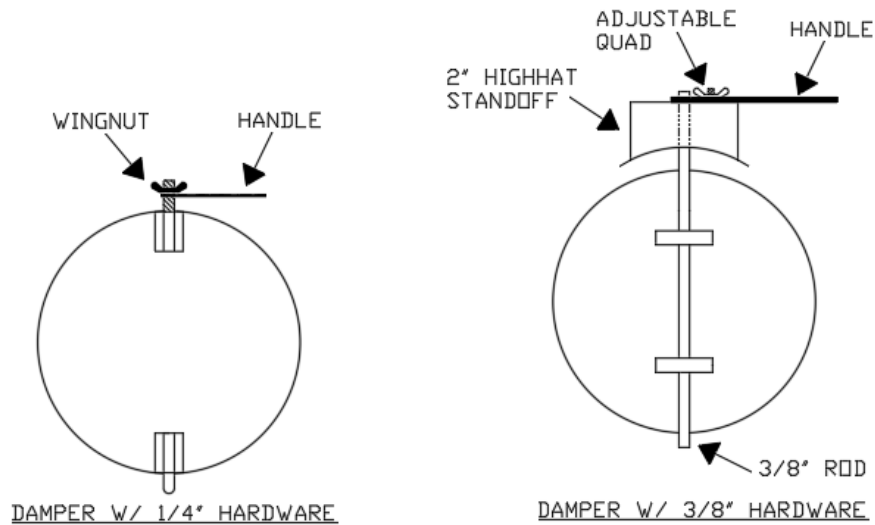

- **DAMPER AVAILABLE IN SLEEVES, LOOSE, OR INSTALLED IN SPIRAL PIPE AND FITTINGS**
- **DAMPERS UP TO 16" ROUND WILL BE 1/4" HARDWARE**
- **DAMPER 18" AND ABOVE WILL BE 3/8" ROD HARWARE**
- **RAPID STANDOFFS AVAILABLE FOR 1/4" HARDWARE**

